



ULTRAFILTER
THE FILTRATION MANUFACTURER

Kronsbein ultrafilter®



Process Filter P-SWM

Particle Filter from Pleated Stainless Steel

For Gases, Liquids and Steam

Process Filter P-SWM

Ultrafilter P-SWM

The Ultrafilter P-SWM filter is used for particle filtration of gases, liquids and steam.

The P-SWM consists of a regenerable, pleated filter tube made of stainless steel. Due to its robust construction, the P-SWM filter is designed for maximum differential pressures up to 10 bar. It can be used in a temperature range from -20°C to 210°C without any problems. From a temperature of 180°C, however, special O-rings are required.

The separation efficiency ranges from 1 µm to 25 µm in order to reliably retain impurities. The improved steam quality not only extends the service life of the filters to be sterilized, but also increases the cost effectiveness of the entire process. All filter elements have been manufactured without the use of binders or other chemical additives.

Features and Benefits

- Good material resistance to steam and aggressive gases.
- Regeneration by ultrasonic bath and back flushing.
- For the filtration of air, gas, steam & liquids.
- High dirt holding capacity at low differential pressure and high flow rate due to pleated stainless steel medium.
- Retention rate up to 0.01 µm saturated steam

Features	Benefits
Filter medium and end caps made of stainless steel	Good resistance to most liquids, gases and aggressive vapours
Separation rates of 1 µm, 5 µm and 25 µm (98% for steam and 100% for gases)	Precisely defined particle retention rate
Multiple regenerable with ultrasound and backwashing	Minimal filtration costs, especially with high dirt quantities
Available in 14 sizes	Optimum adjustment to the respective application or volume flow rate
Stainless steel components	Temperature range from -20 °C to 210 °C
Stainless steel support body and end caps	Temperature range from -20°C to 210°C.

Fields of Application

- Breweries
- Chemical industry
- Dairies
- Electronics industry
- Fermentation processes
- Food and beverage industry
- Pharmaceutical industry
- Plastics industry
- Packaging industry

Materials	
Filter medium	Stainless steel 1.4404/316L
Support coats	Stainless steel 1.4404/316L
End caps	Stainless steel 1.4404/316L
Sealing rings	EPM**
** Silicone, Buna N, Viton, Fluoraz on request	



Kronsbein ultrafilter®

ultrafilter gmbh

Otto-Hahn-Str. 1 • 40721 Hilden • Germany
Tel: +49 (0) 21 03.33 36 13 • Fax +49(0)21 03.33 36 36
e-Mail: info@ultra-filter.de • www.ultra-filter.de

Process Filter P-SWM

Filtration Area:

0,18 m² per 10" element (10/30) (250 mm)

Temperature Range:

-20 °C bis 210 °C
> 180°C only with special O-rings

Conversion Factor for Steam Temperature

Steam temperature	°C	110	121	140	160
	°F	212	250	285	320
Conversion factor		0,5	1	2	3

Dimensions (mm)

Element size	A mm	B mm	Ø C mm	Ø D mm	Correction Factor
03/10	76	12	3/4"	42	0,17
04/10	104	12	3/4"	42	0,28
04/20	104	14	1"	52	0,28
05/20	128	14	1"	52	0,33
05/25	128	14	1"	62	0,39
05/30	128	16	2"	86	0,45
07/25	180	14	1"	62	0,56
07/30	180	16	2"	86	0,67
10/30	254	16	2"	86	1,00
15/30	381	16	2"	86	1,56
20/30	508	16	2"	86	2,11
30/30	762	16	2"	86	3,28
10/50	254	16	3"	140	1,45
30/50	762	16	3"	140	4,34

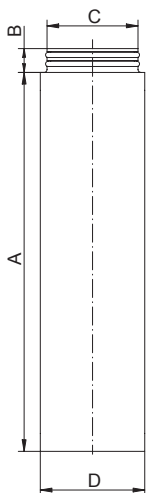

Subject to technical changes

Absolute Separation Rates:

1 µm bis 25 µm

Max. Differential Pressure:

10 bar

P-SWM, 10/30, Air, 20°C, 1 bar absolut

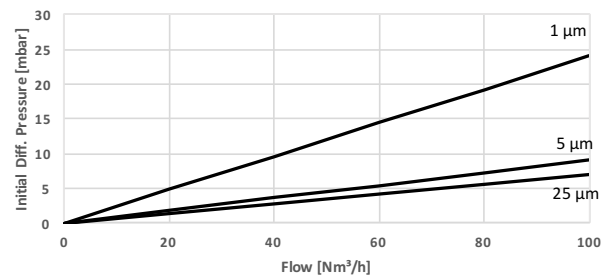

P-SWM, 10/30, Steam, 121°C, 2 bar absolut

